



## 1 HOSPITAL

### Ground Floor

- Café
- Pharmacy

### First Floor

- Administration
- Business Office
- Gift Shop
- Health Information Management/ Medical Records
- Human Resources
- Marketing

### Second Floor

- Education
- Intensive Care Unit (ICU)
- Information Technology
- Patient Rooms

### Third Floor

- Birthing Center
- Patient Rooms
- Social Services

### KEY

- V** VISITOR PARKING
- E** EMPLOYEE PARKING

## 2 CLINIC

### Providers

- Family Practice
- General Surgery
- Geriatric Services
- Internal Medicine
- Pediatrics
- Walk-in Clinic

### Specialists

- Ear, Nose & Throat (ENT)
- Eye Services
- Neurology
- Obstetrics/Gynecology/ Women's Health
- Psychiatry & Behavioral Health
- Rheumatology
- Urology

### Other Services

- Diabetic Services
- Imaging Services
- Lab Services
- Pharmacy

### Additional Services

- Physician's Optical
- Professional Hearing Center Audiologists
- Summers Pharmacy

## 3 OUTPATIENT

### Cancer Center

- Oncology & Hematology

### Outpatient Treatment Center

- Bariatric & Metabolic Clinic
- Cardiac & Pulmonary Rehabilitation
- Cardiology
- Dermatology
- Infusion Therapy
- Maternal Fetal Monitoring
- Nephrology
- Neurosurgery
- Pulmonology
- Vascular Clinic
- Wound & Ostomy Clinic

### Other Services

- Endoscopy
- Imaging Services
- Lab Services
- Pain Management
- Pulmonary Services
- Registration
- Respiratory Therapy & EKG
- Surgical Services
- Sleep Studies

### Additional Services

- The Bistro

## 4 EMERGENCY

- Emergency Room

## 5 EAST CAMPUS

- Imaging Services
- Orthopedics
- Podiatry

## 6 RADIATION ONCOLOGY SERVICES

- Coming Soon

## 7 WEST CAMPUS

- Ambulance Services
- Therapy Services

## 8 HOME SERVICES

- Home Health Services
- Hospice Services



[gvmh.org](http://gvmh.org) | [@chooseGVMH](https://www.instagram.com/chooseGVMH)  
660.890.7300

# FIRST FLOOR

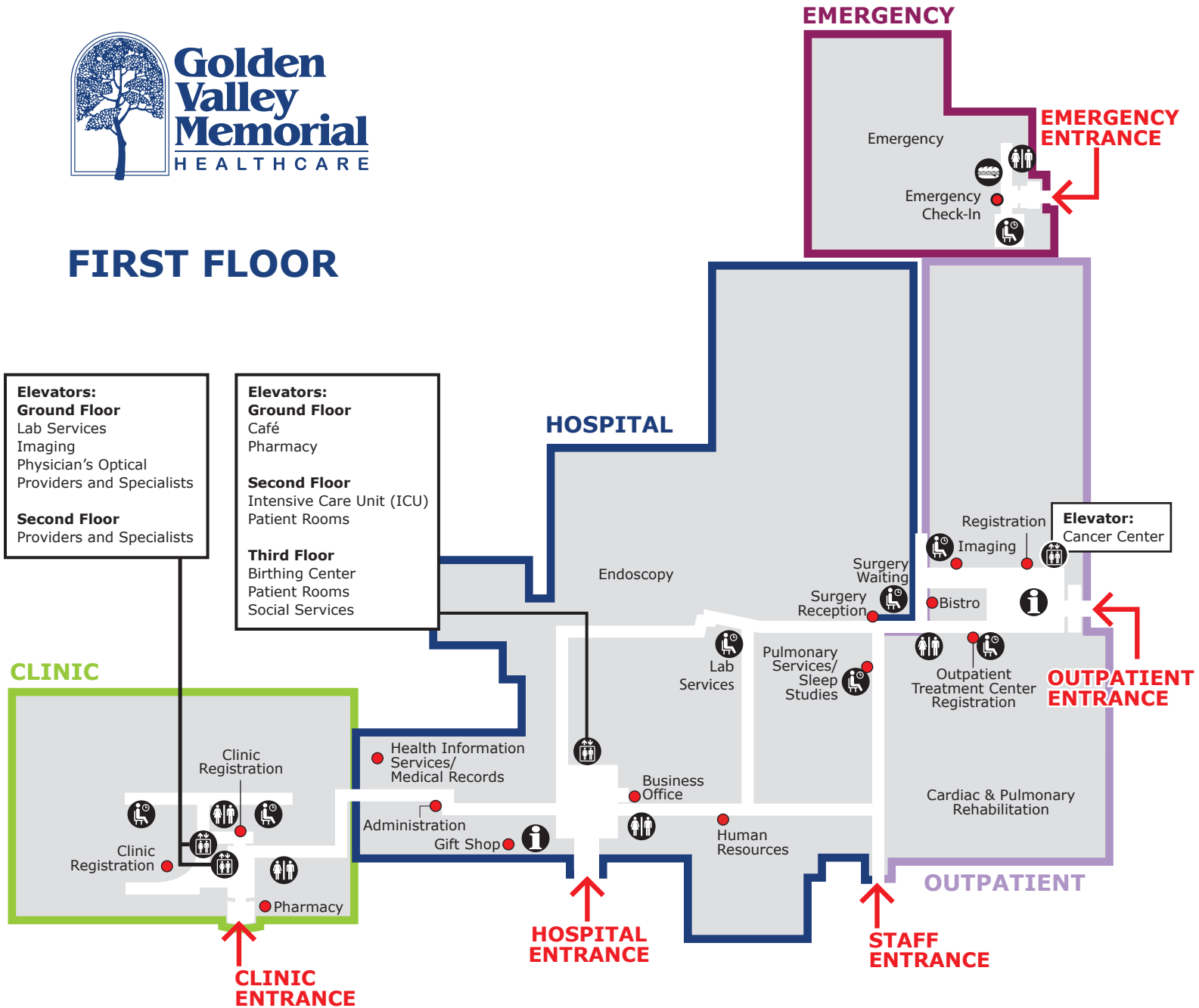

**Elevators:**  
**Ground Floor**  
Lab Services  
Imaging  
Physician's Optical  
Providers and Specialists

**Second Floor**  
Providers and Specialists

**Elevators:**  
**Ground Floor**  
Café  
Pharmacy

**Second Floor**  
Intensive Care Unit (ICU)  
Patient Rooms

**Third Floor**  
Birthing Center  
Patient Rooms  
Social Services

**Elevator:**  
Cancer Center

## CLINIC



### MAP KEY

- Information
- Elevators
- Restrooms
- Waiting
- Vending

DEPARTMENT	BUILDING	FLOOR
Administration	Hospital	1
Birthing Center	Hospital	3
Bistro	Outpatient	1
Business Office	Hospital	1
Café	Hospital	G
Cancer Center	Outpatient	2
Cardiac & Pulmonary Rehabilitation	Outpatient	1
Clinic Registration	Clinic	1
Emergency	Emergency	1
Emergency Registration	Emergency	1
Endoscopy	Hospital	1
Gift Shop	Hospital	1
Health Information Services/ Medical Records	Hospital	1

DEPARTMENT	BUILDING	FLOOR
Human Resources	Hospital	1
Imaging	Outpatient	1
Registration	Outpatient	1
Intensive Care Unit (ICU)	Hospital	2
Lab Services	Clinic	G
Lab Services	Hospital	1
OTC Registration	Outpatient	1
Patient Rooms	Hospital	2,3
Pharmacy	Hospital	G
Pharmacy	Clinic	1
Sleep Studies	Hospital	1
Surgery Reception	Hospital	1
Surgery Waiting	Hospital	1